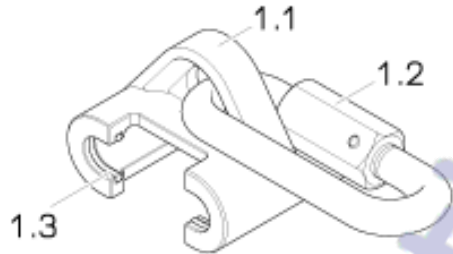

**Fig. 3**



## Instruction for use and maintenance

### Anchorage Device „Söll-MultiRail“ horizontal

closed glider complying with DIN EN 795

Part-No. 17407

## E Storage

As the design of the runner is simple and without any movable parts, it can remain in the system without any problems.

## F Care

Before inserting the runner or attaching the lanyard in the eyelet it must already be ascertained that the polyamide semi-circles (1.3) are not worn out. Also, if the runner remains in the system, this must be checked.

Serial number: \_\_\_\_\_

Year of manufacture: \_\_\_\_\_

Date of purchase: \_\_\_\_\_

(The following must be completed by the operator in permanent waterproof ink.)

Date of initial operation: \_\_\_\_\_

Operator/user: \_\_\_\_\_

Street: \_\_\_\_\_

Place: \_\_\_\_\_

Phone: \_\_\_\_\_

Fax: \_\_\_\_\_

Issue: 04.08.2009  
SE 26







## B Checking before use

- B 1. Ensure that the runner, safety harness, lanyard with a DIN EN 355 compliant fall arrestor, a fall arrestor or a travelling safety device as well as guide rails (= anchorage device) are in the flawless working condition and are functioning properly before and during their every use. Ensure that the device and the components are not deformed or damaged.
- B 2. The Söll „Söll-MultiRail“ system may not be used if there are any doubts regarding its safe use, if defects are visible, or if the device has been strained as a result of a fall. It may not be used until written permit is given by a specialist. If necessary, the "Söll-MultiRail runner" should be returned to the manufacturer.

**Attention!**

A specialist is not authorised to carry out repairs!

- B 3. Before each use, it has to be ensured that there is sufficient fall clearance beneath the operator, so that in case of a fall, he cannot strike the ground or against other obstacles.

## C Using the runner

The Söll anchorage device should be used only by personnel who are trained to handle this device safely. Every user must use a separate runner!

Fit the EN 361 safety harness in accordance with the applicable instructions.

Maintenance checklist, see Fig. 3

	1	2	3	4	5
Year					
Date					
Name of the specialist					
Signature					
Reason for the revision*					
Ext. inspection is due					
<b>Item 1</b>					
<b>Body (1.1)</b>					
Free of dirty					
Marking well legible					
No relevant changes (i.e., due to a fall)					
Has no cracks in the body of the runner					
<b>Item 2</b>					
<b>Suspension eyelet (1.2)</b>					
Not bent					
Has no cracks					
Tensioning pin present					
Tensioning pin undamaged					
<b>Item 3</b>					
<b>Polyamide-semi-circle (1.3)</b>					
All 4 inlays present					
Wear-out limit (metal superficies rubs on the rail) not yet reached					
Not bent, i.e. due to a fall					

## D Maintenance

- D 1. The regular maintenance of the "Söll-MultiRail runner" are to be performed considering the legal regulations, the conditions of use and environmental conditions. Maintenance must be performed by a competent person, at least once a year.

**A competent person for the maintenance of this equipment is**

a person suitably trained or qualified by knowledge and practical experience to enable the maintenance to be performed properly.

- D 2. Regular maintenance is essential as the safety of the operator depends from the effectiveness and durability of the equipment.
- D 3. **Maintenance checklist** (see fig.3)

The checklist has to be completed and signed by a competent person by means of an indelible pen. The single check points have to be marked respectively with "OK" or "D" (defect). The competent person is responsible for the accuracy of the information provided therein. Check points marked with a "D" can be corrected by a competent person only when the defect to be corrected concerns the removal of dirt (paint, mortar, concrete) or when markings need to be cleaned. This procedure must be noted in the annex of the check list (remarks), complete with date and signature of the competent person. The due date of the next regular inspection must also be indicated.

In case the correction of defects requires a partial disassembling of the components, the "Söll-MultiRail runner" must be returned to the manufacturer together with the manual and with a relevant comments concerning the defect.

**If using:**

- a safety rope with EN 355 fall arrester, attach this to the back eyelet of the safety harness in accordance with the instructions.

**Important!**

The fall arrester must always be on the body side!

- a travelling fall arrester with flexible guide, use only equipment that the manufacturer has guaranteed will also function in the planned direction of strain.

**Attention!**

The runner is to be inserted in the guide rail and the user may attach to the runner only when he is in a position secured against falls. Before removing the runner or detaching from the lanyard, (safety line, guided type fall arrester) safety against falls has to be otherwise provided.

C 1. **Mounting/removing the runner**

**Warning:**

Before removing the runner from the guide rail, you must take other measures to ensure protection against falls.

### 1. Alternative

**Use:** Fixed end stop (Part-No. 17404)

**Fig. 1**

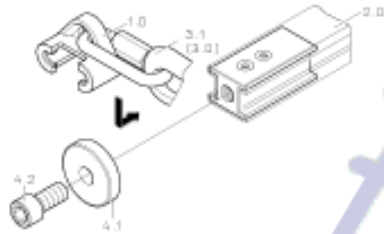

Remove the stop plate (4.1) by detaching the screw (4.2). Insert the runner (1.0) into the guide rail „Söll-MultiRail“ (2.0). Hereinafter, fix the stop plate (4.1) again by means of the screw (4.2), to avoid accidental gliding out of the runner. Now, the runner can be moved freely on the guide rail (1.1). To detach the runner, screw out the stop plate (4.1) and remove the runner from the rail. Finally, fix the stop plate again by means of the screw.

### 2. Alternative

**Use:** Rail end stop with exit (Part-No. 23956)

**Fig. 2**

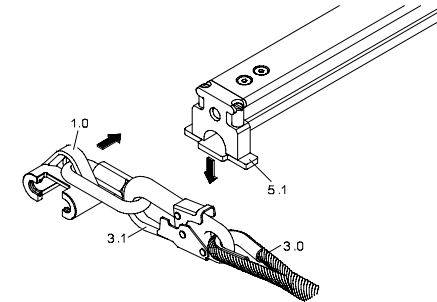

Press the unlocking plate (5.1) downwards with one hand and **place** the runner (1.0) onto the guide rail (2.0) with the other. The runner can now move freely on the guide rail (2.0).

While **detaching**, press the unlocking plate (5.1) downwards and pull the runner out from the rail.

**Caution!**

The unlocking plate (5.1) must be pressed to the initial position using spring force.